

MnZn Ferrite EP Cores

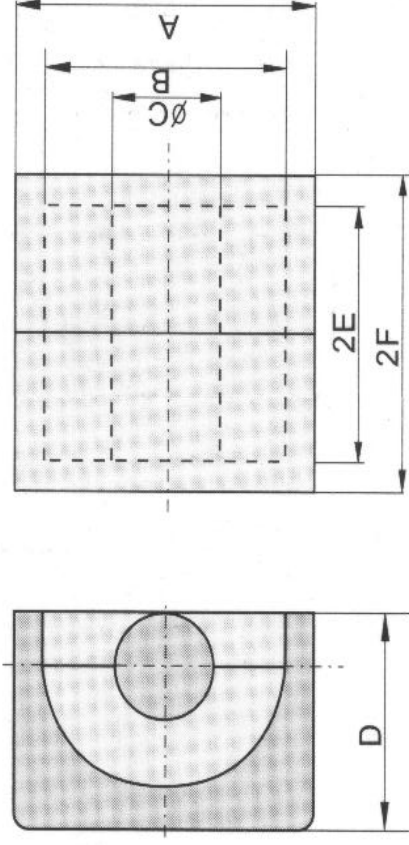

Part no.	Dimensions (mm)										C1 (mm^{-1})	Le (mm)	Ae (mm^2)	Ve (mm^3)	Weight (g)	AL (nH/N ²) $\pm 25\%$
	A	B	C	D	2E	2F										
EP7	9.2 ± 0.2	7.4 ± 0.2	3.2 ± 0.2	6.35 ± 0.15	5.2 ± 0.2	7.4 ± 0.1	1.45	15.50	10.70	165.85	1.40	2300 μi	1200			
EP10	11.5 ± 0.3	9.4 ± 0.2	3.3 ± 0.15	7.65 ± 0.2	7.4 ± 0.2	10.3 ± 0.1	1.70	19.20	11.30	216.96	2.80	1100	1500			
EP13	12.5 ± 0.3	10.0 ± 0.3	4.35 ± 0.15	8.8 ± 0.2	9.2 ± 0.2	12.85 ± 0.15	1.24	24.20	19.50	471.90	5.10					
EP17	18.0 ± 0.5	12.0 ± 0.5	5.68 ± 0.17	11.0 ± 0.25	11.5 ± 0.3	16.8 ± 0.2										
EP20	24.0 ± 0.5	16.5 ± 0.4	8.75 ± 0.25	14.95 ± 0.35	14.3 ± 0.3	21.4 ± 0.2										